

CERTIFIED LAND CORNER RECORDATION

DESCRIPTION OF CORNER EVIDENCE FOUND, AND ORIGINAL RECORD (if known)

1/4" PIPE WITH STEEL FENCE POST, SW COR. SEC. 24
 (Landowner verified this is corner)
 T. 13 N., R. 68 W., 6th PM
 LARAMIE COUNTY, WYOMING

DESCRIPTION OF MONUMENT AND ACCESSORIES ESTABLISHED TO PERPETUATE THE ORIGINAL LOCATION OF THIS CORNER:

DISTANCE TO S 1/4 CORNER OF SECTION 25 IS 2641.49 FEET
 SET POINT 1320.75' EAST

ALLEGEDLY
 LARAMIE COUNTY
 CHEYENNE, WY.
 '87 JUN 9 PM 2 17

029752

SKETCH, WITH COURSE AND DISTANCE TO ADJACENT CORNER IF DETERMINED IN THIS SURVEY.
 (May Sketch or Paste Reproduction on Reverse Side.)

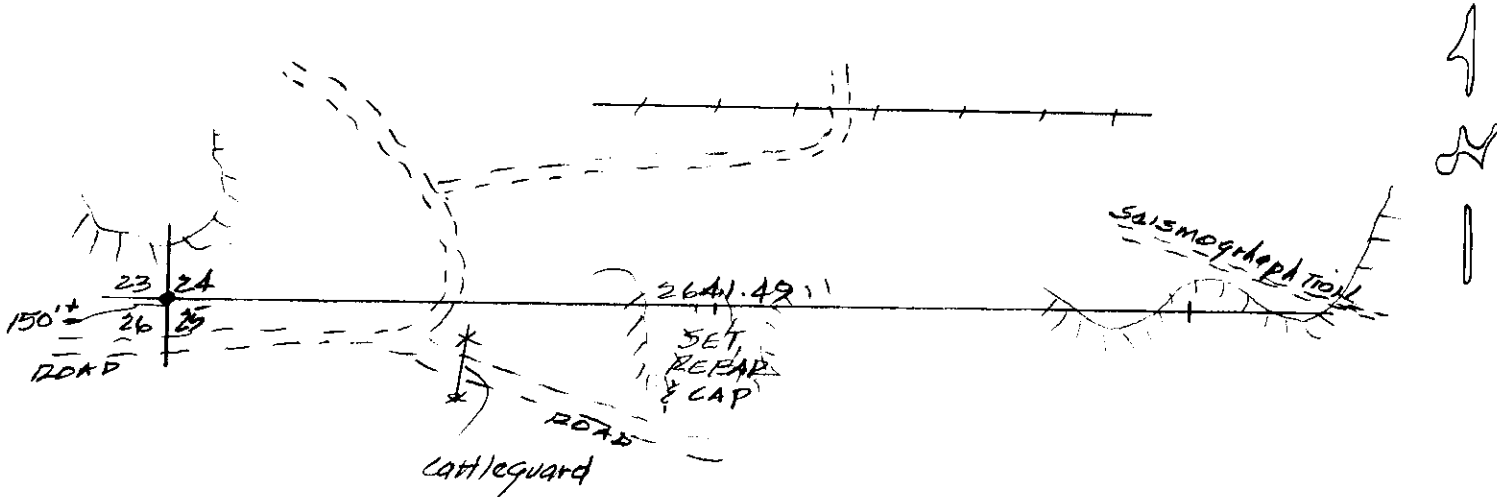

I, DONALD M. HOPKINS certify that I have carefully performed or reviewed the work done on the diagrammed corner as reported on this recordation form and approve the same.

Donald M. Hopkins Signature of Surveyor
 558 Registration No.

STATE OF WYOMING,
 Office of Clerk and Recorder,
 County of Laramie

This "corner record" was filed for record on the 9th day of June, 1987, was noted on the cross-index plat and is assigned page No. _____, in book No. _____

Janet C. Whitehead
 County Official
 Cross Index No. R-21 T. 13 R. 68 Mer.
 _____ T. _____ R. _____ Mer.
 _____ T. _____ R. _____ Mer.
 _____ T. _____ R. _____ Mer.
 _____ T. _____ R. _____ Mer.
 _____ T. _____ R. _____ Mer.
 _____ T. _____ R. _____ Mer.